

EVOLUCIÓN DE LA FORMA I

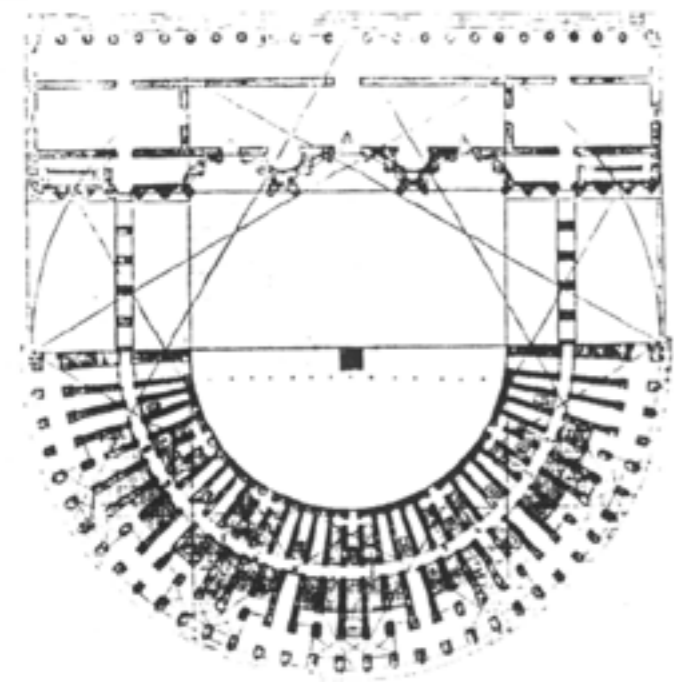

Teatro Vitruviano.

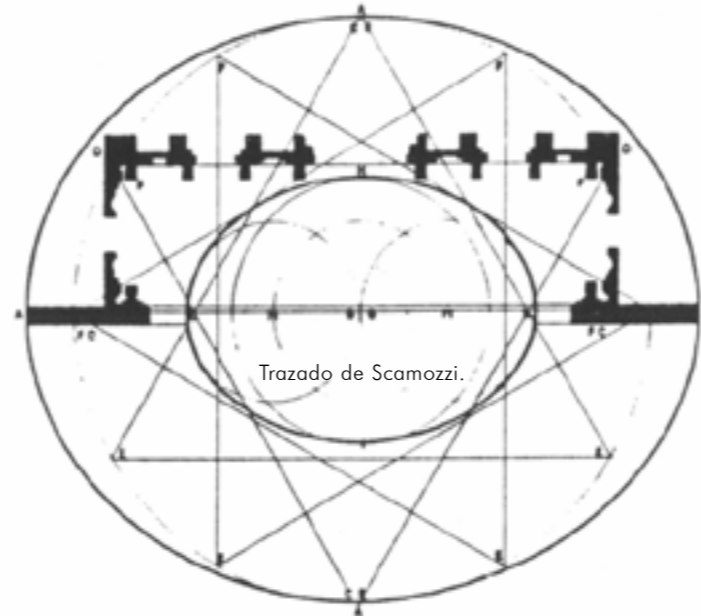
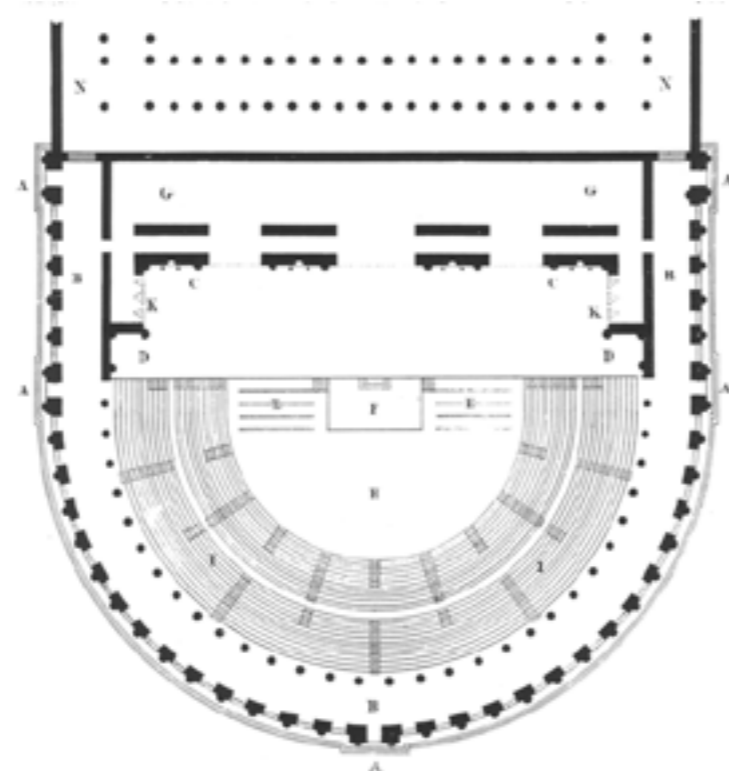

Teatro degli Antichi.

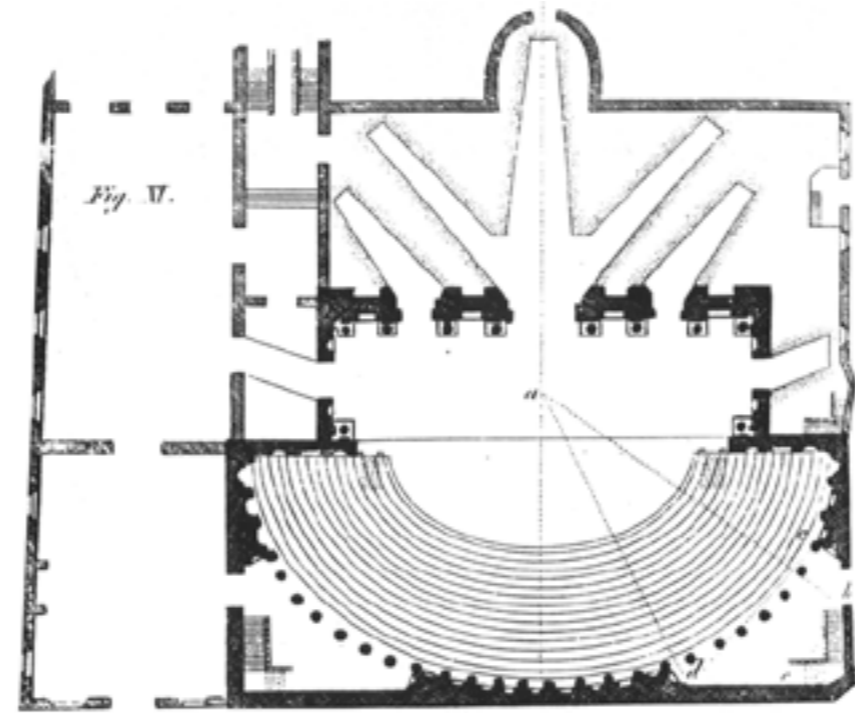

Teatro Olímpico de Vicenza.

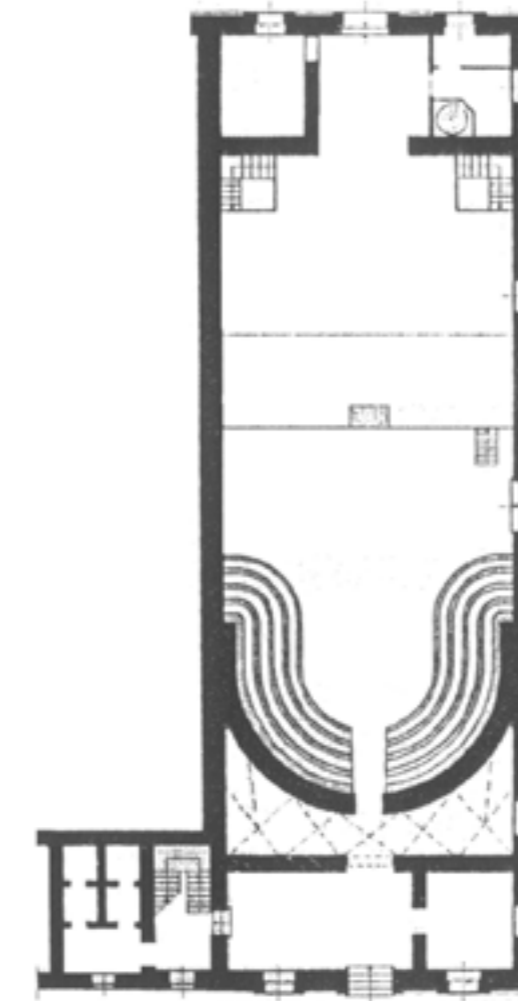

Teatro de Sabbionetta.

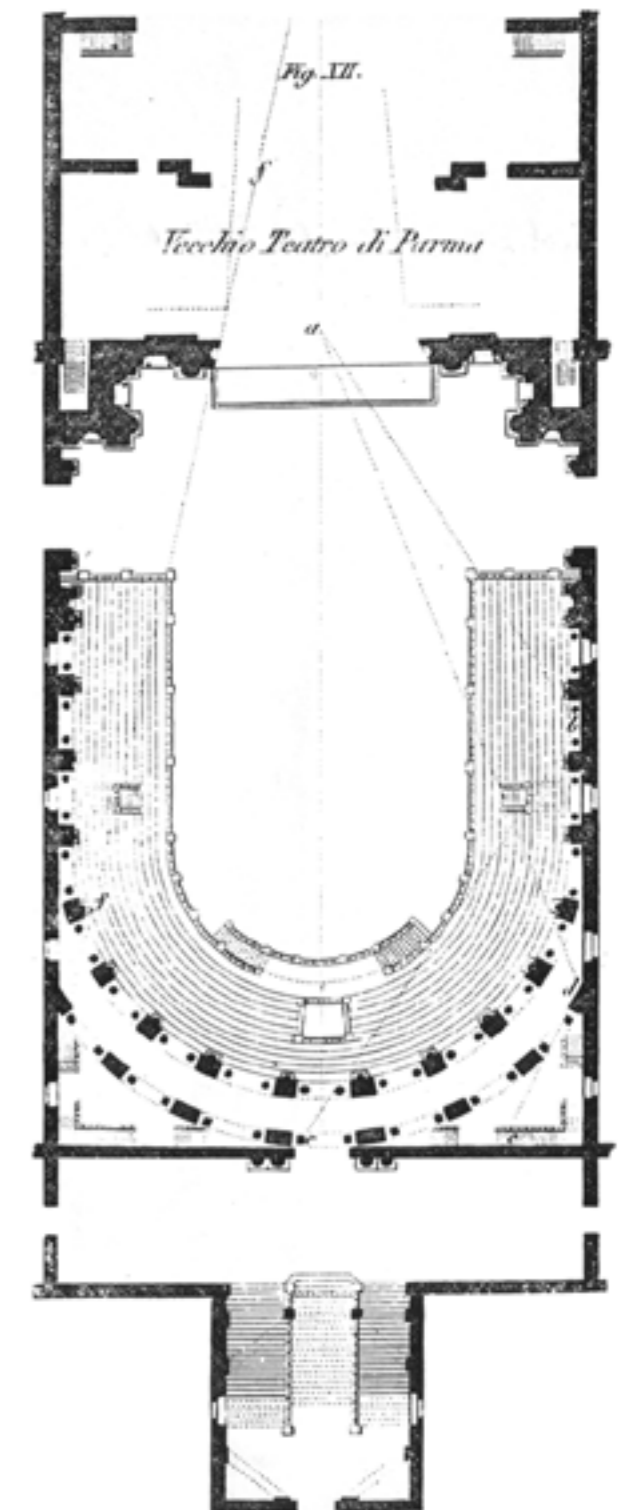

Teatro Farnese de Parma.

Las imágenes no están a escala.

EVOLUCIÓN DE LA FORMA II

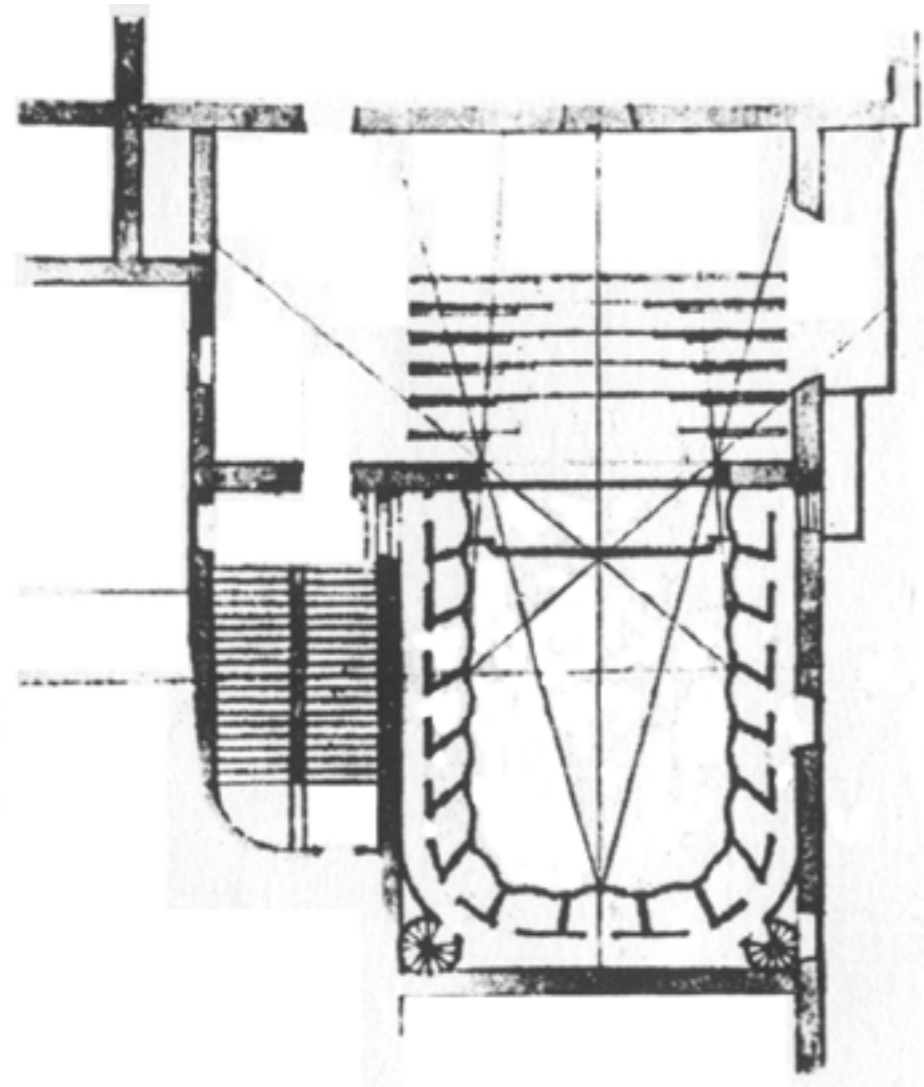

Teatro Ottoboni de Roma.

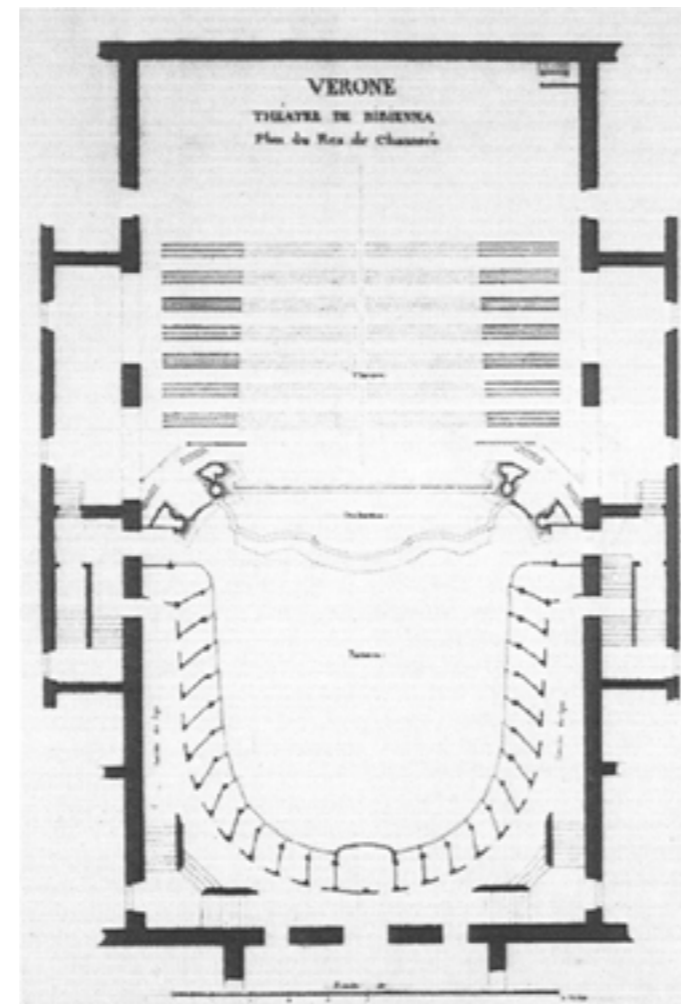

Teatro Filarmónico de Verona.

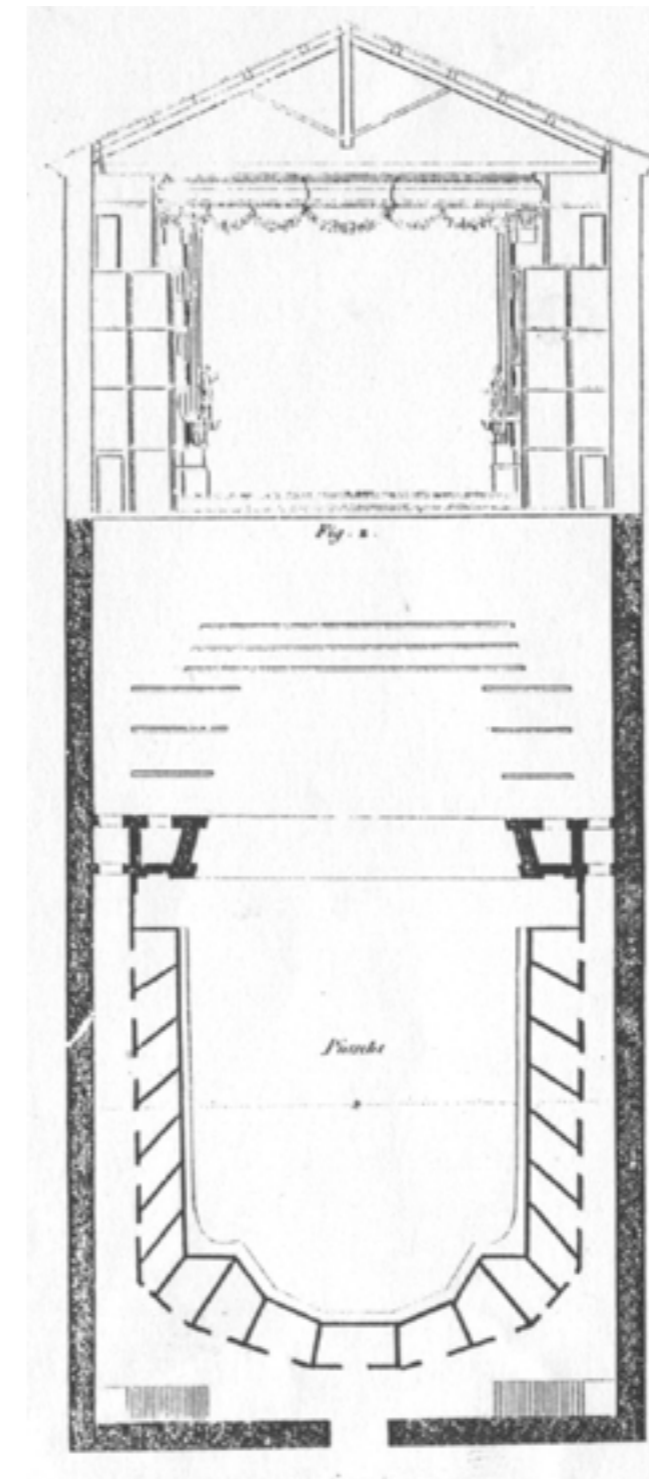

Teatro Fano.

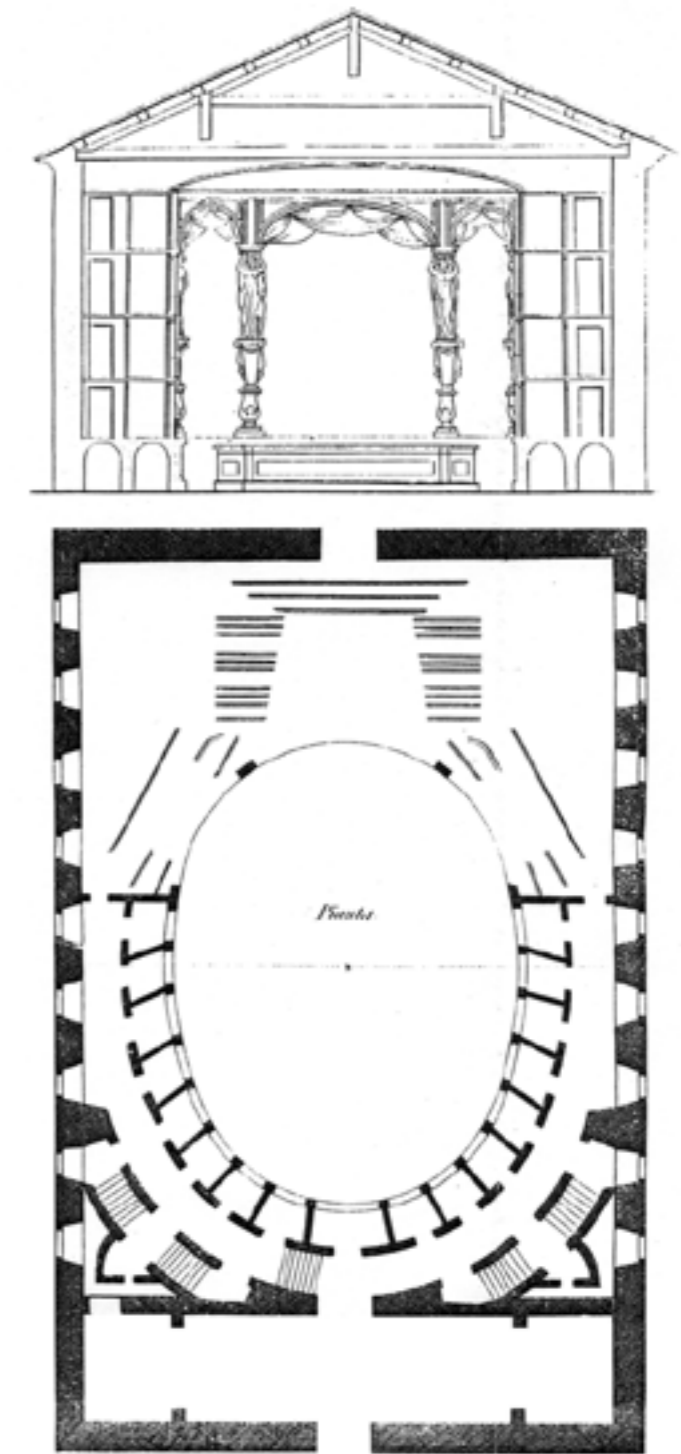

Teatro de Imola.

Las imágenes no están a escala.

EVOLUCIÓN DE LA FORMA III

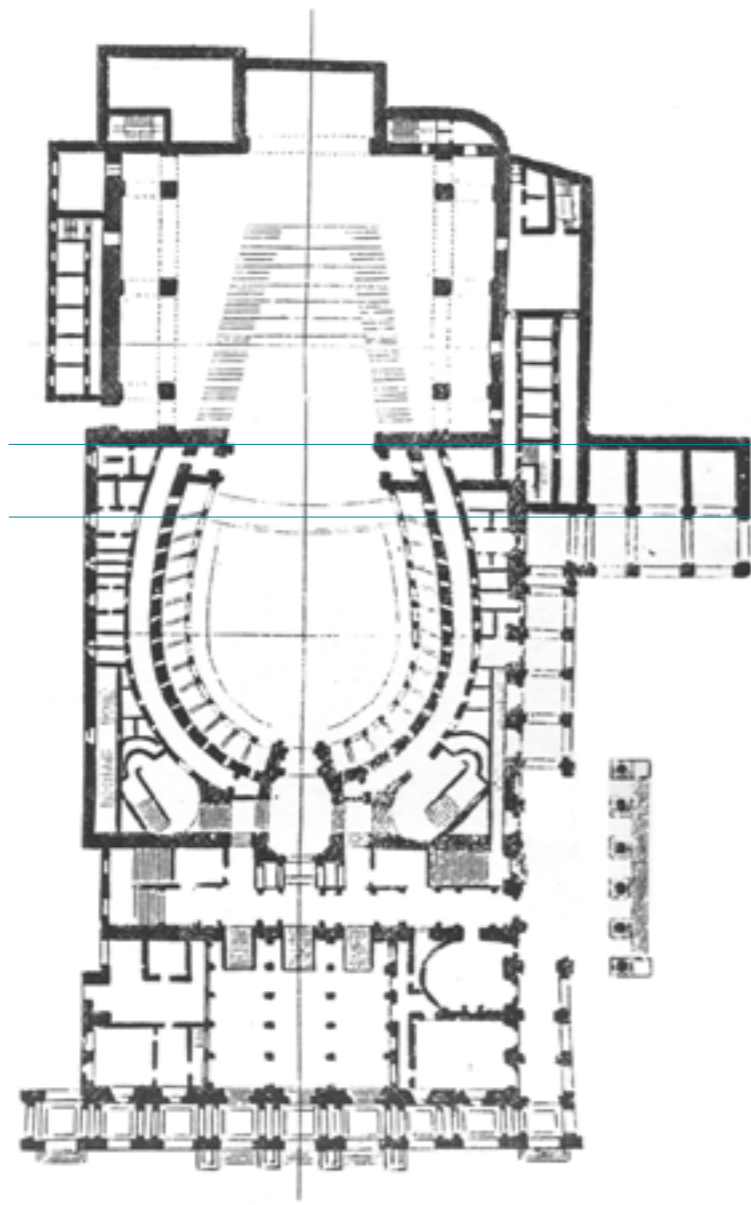

Teatro Carlo Felice, Génova.

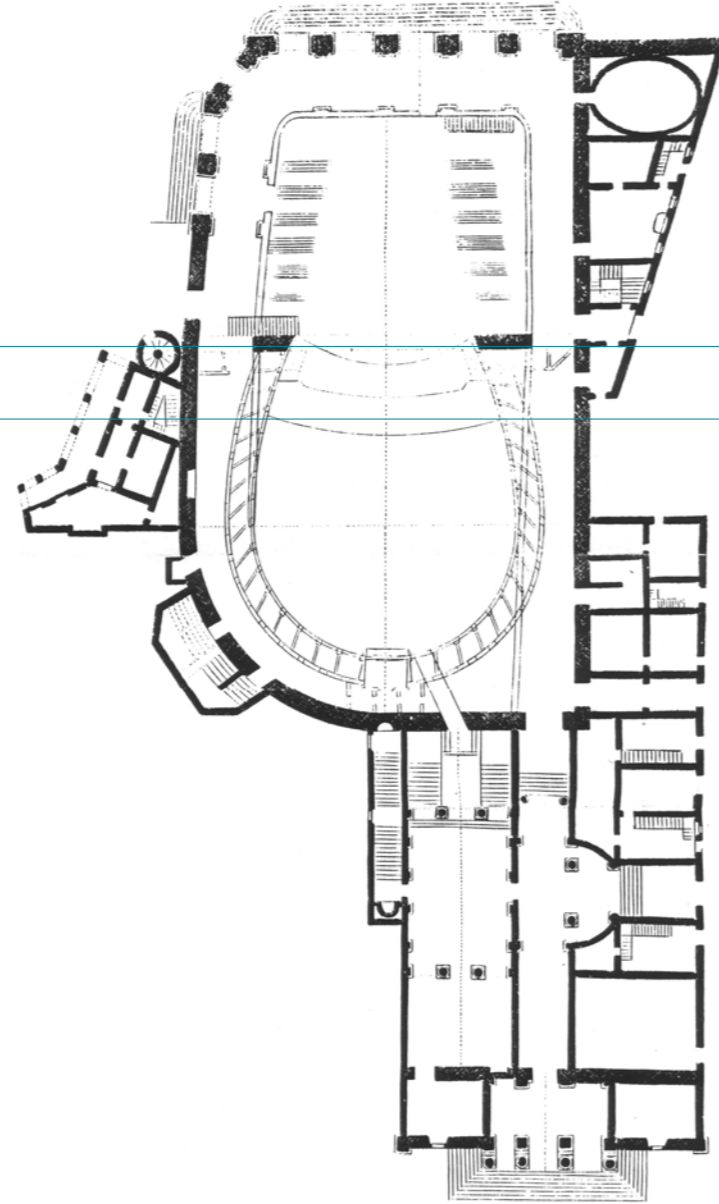

Teatro della Fenice, Venecia.

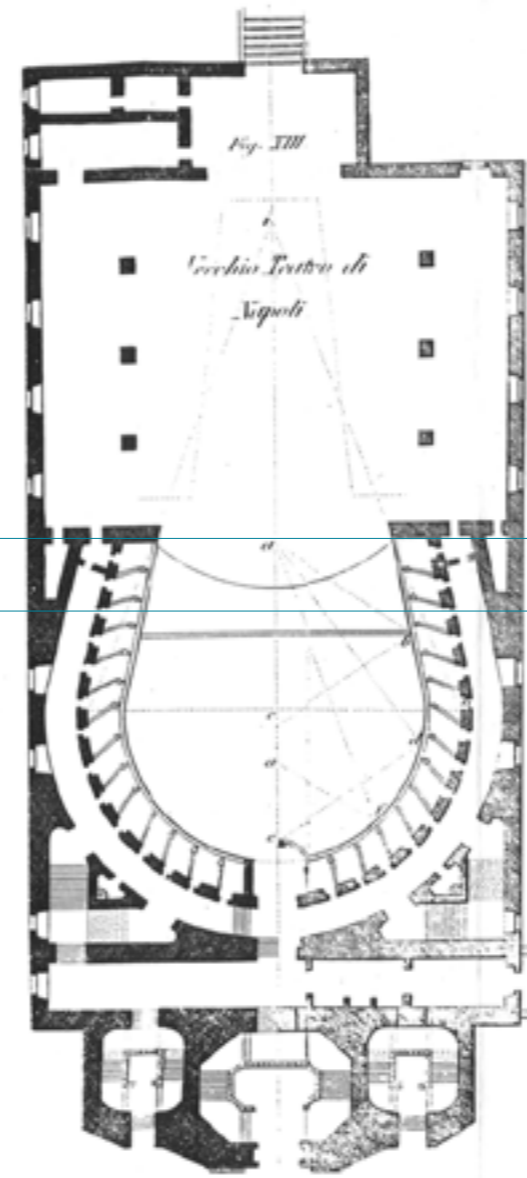

Teatro de Nápoles.

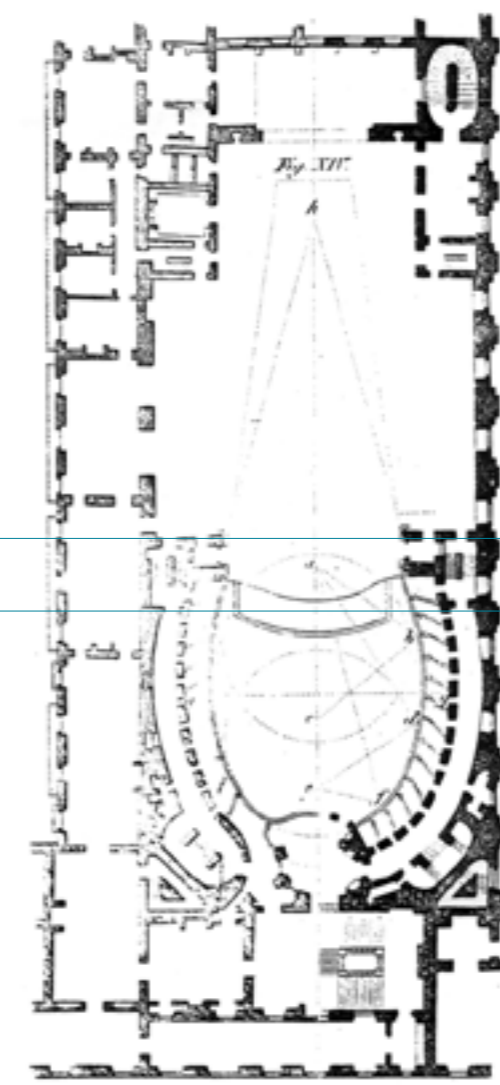

Teatro Regio de Turín.

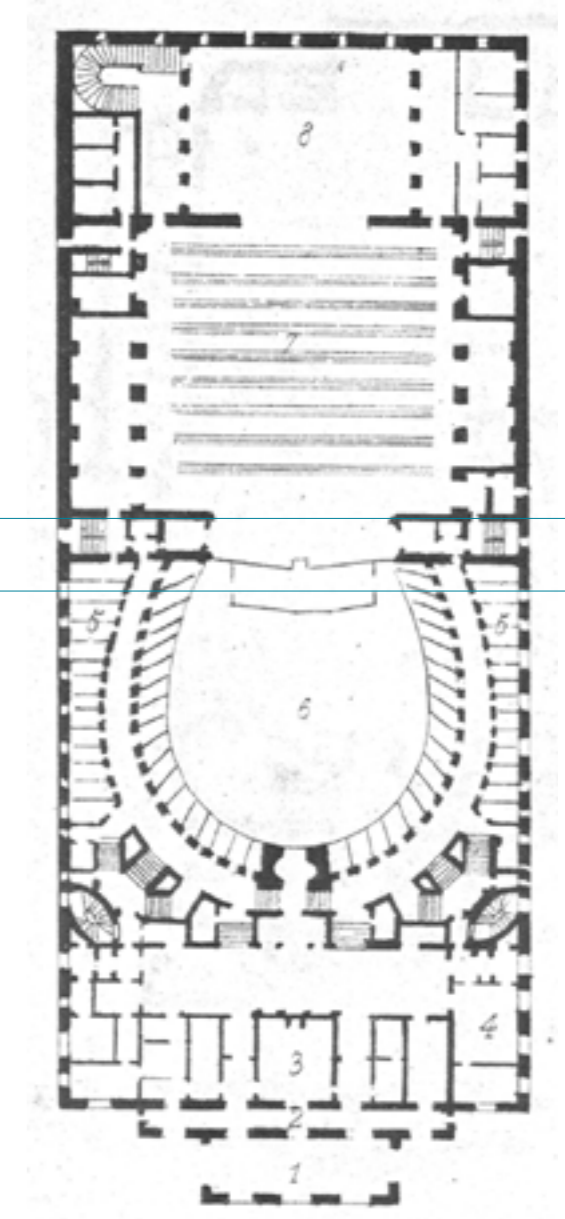

La Scala de Milán.

Las imágenes están a escala.